

# KIOSK

## INSTALLATION MANUAL

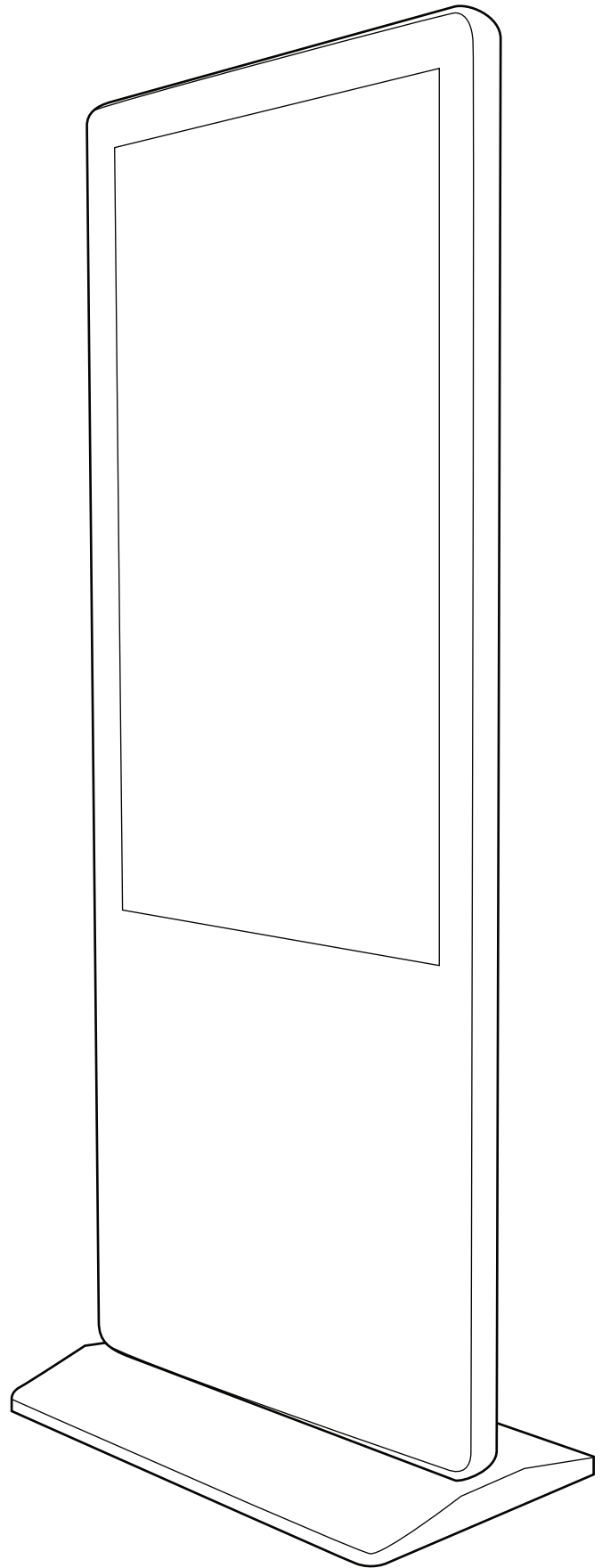

**kuusoft**

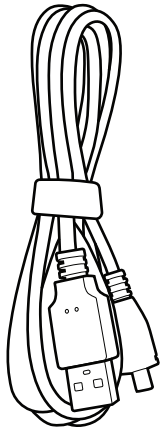

**1x**  
Micro USB  
Cable

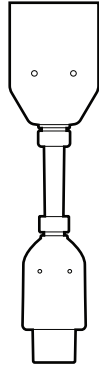

**1x**  
HDMI  
Extender

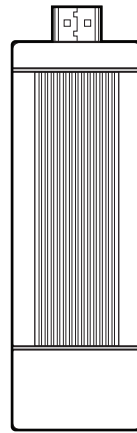

**1x**  
Nano-PC3

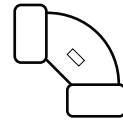

**1x**  
Cornering  
Anchor

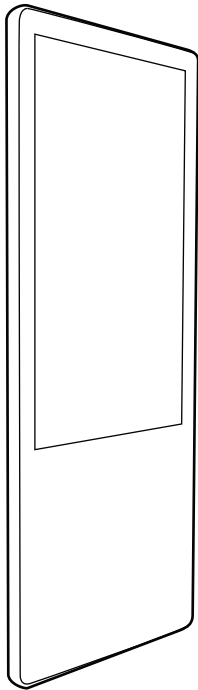

**1x**  
Kiosk Display

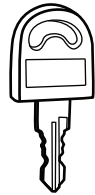

**2x**  
Kiosk Key

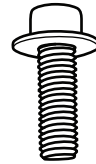

**12x**  
Kiosk Stand  
Screws

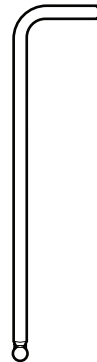

**1x**  
Allen Key

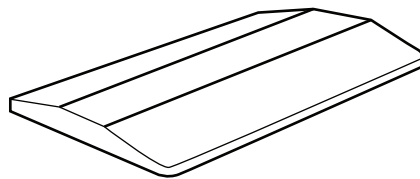

**1x**  
Kiosk Stand

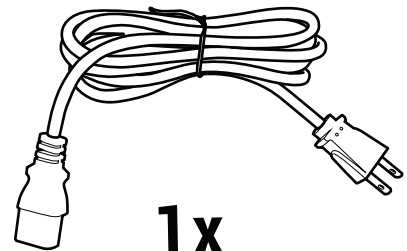

**1x**  
AC Power Cord

**1x**  
Remote (not shown)

# Installing the Kiosk Stand

1. Unbox the Kiosk Display and place it on a flat surface, screen facing up with a minimum of 12" off the ground



2. Attach the Kiosk Stand and tightly screw in the 12 Kiosk Stand Screws using the Allen Key

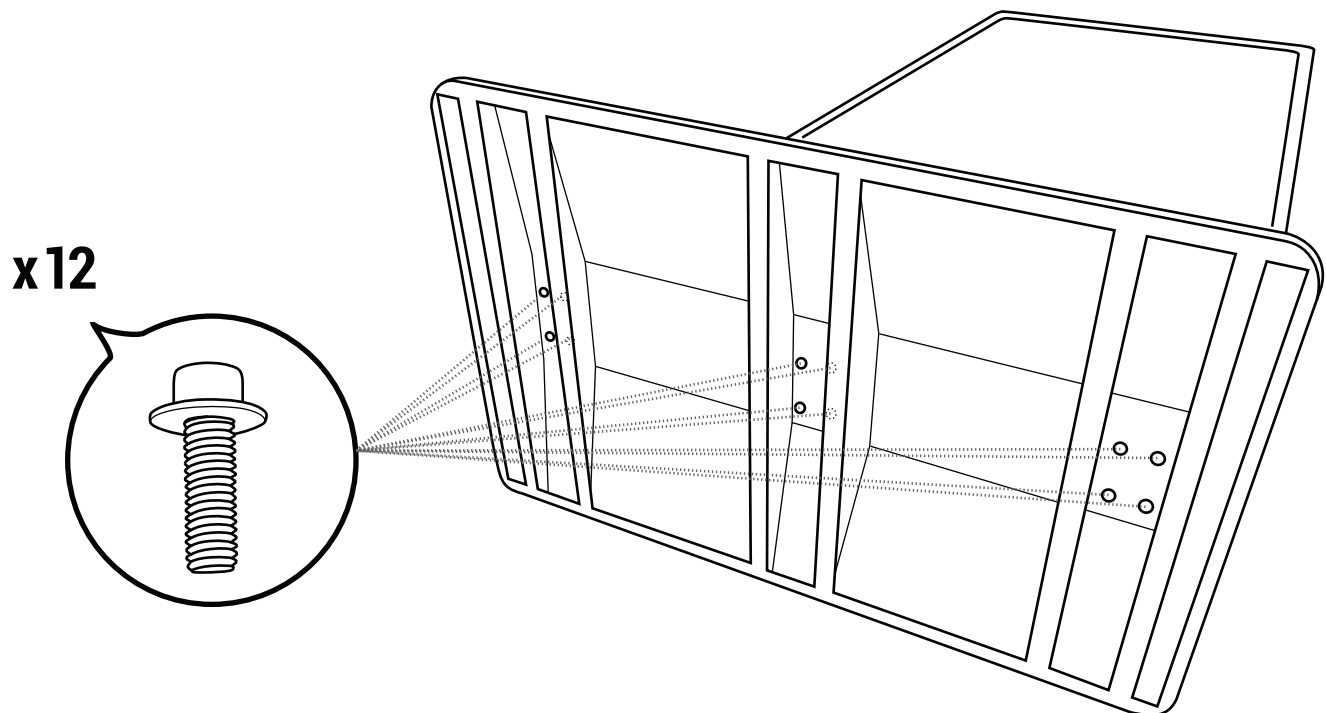

# Installing the Nano-PC3 into the Kiosk

1. Attach the HDMI Extender to Nano-PC3

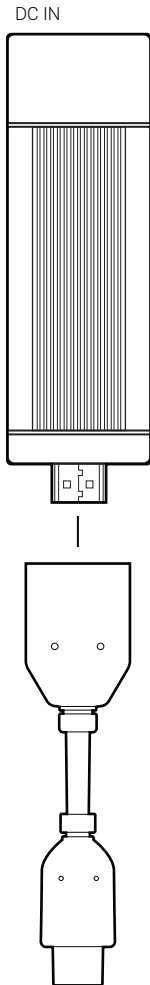

2. Bend the HDMI Extender 90 degrees and attach the Cornering Anchor

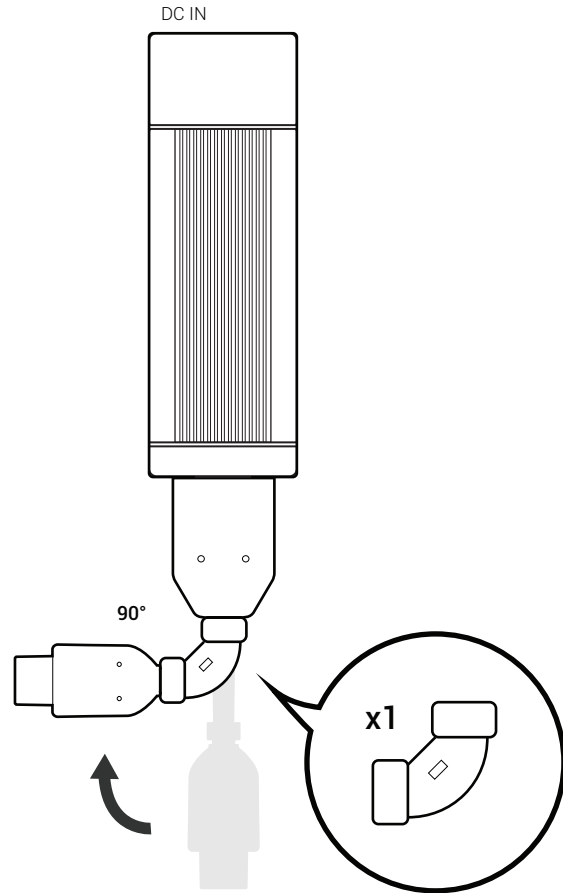

3. Open the back panel of the Kiosk Display with the included Kiosk Key

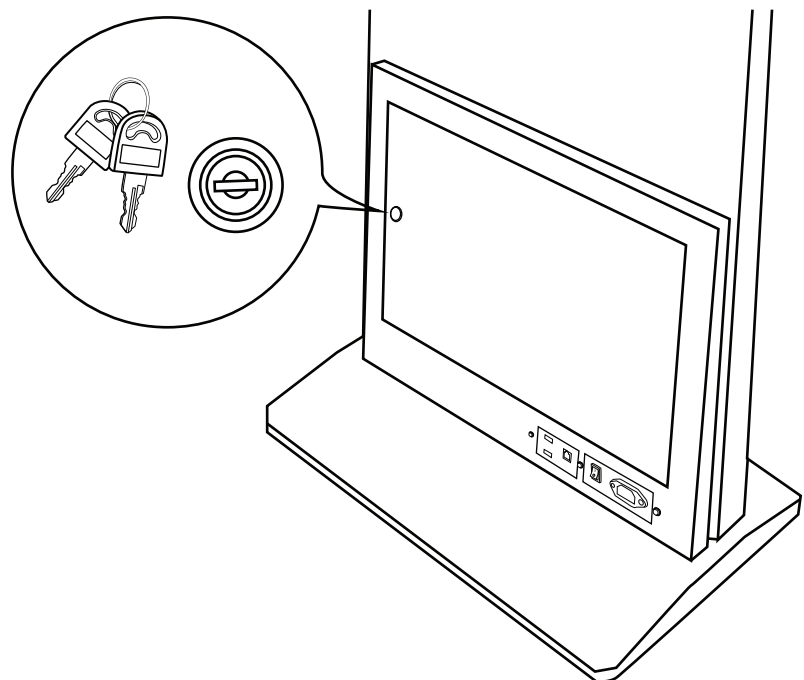

#### 4. Inside the Kiosk

- A** Plug the Micro USB Cable into the “DC IN” port on the Nano-PC3
- B** Plug the HDMI Extender into the HDMI port of the Kiosk
- C** Plug the other end of the Micro USB cable into the USB port of the Kiosk

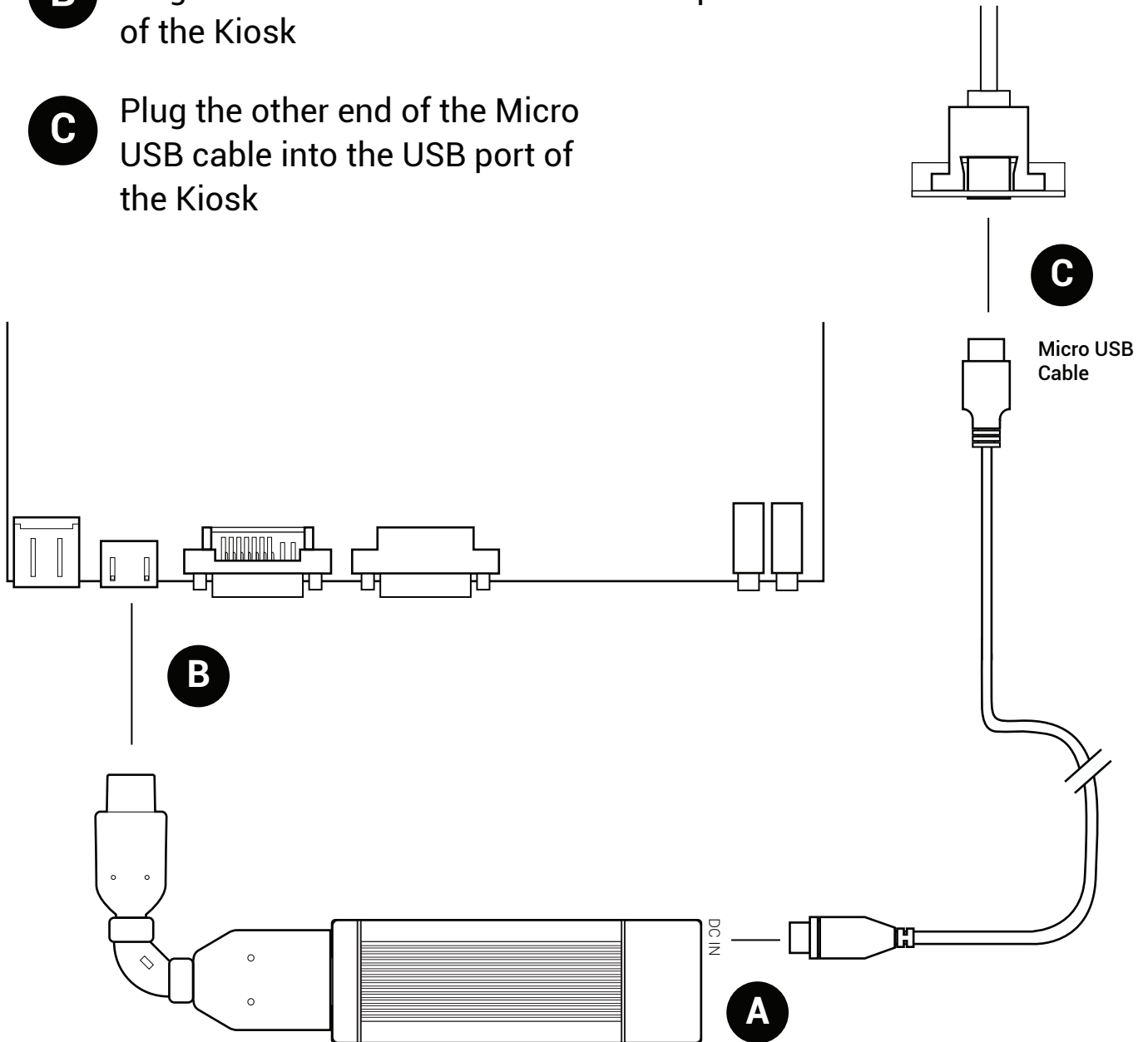

**5. Close the back panel of the Kiosk Display with the included Kiosk Key**

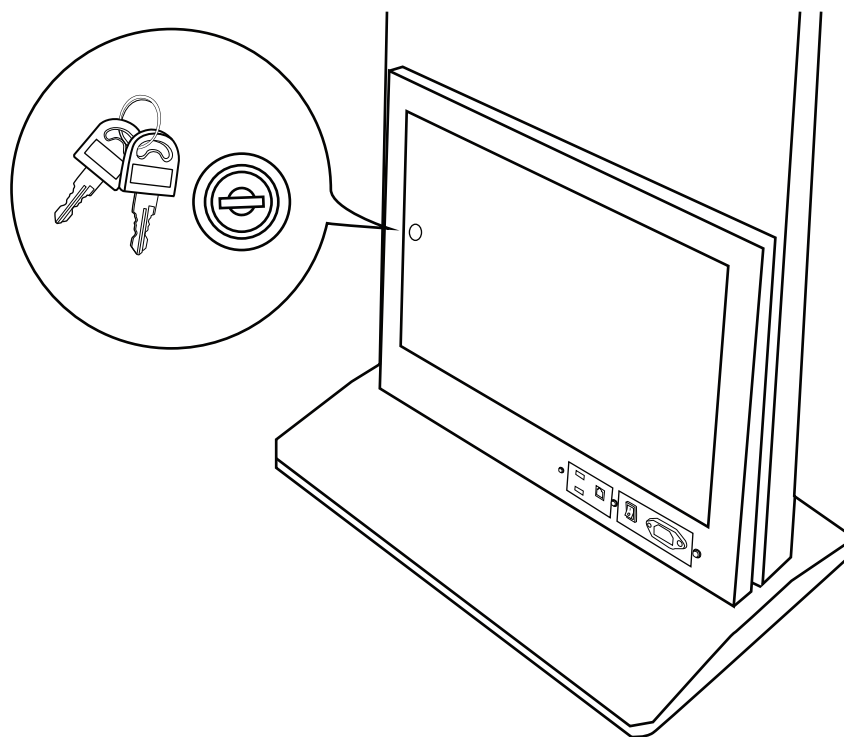

## **Power on the Kiosk**

1. Plug in the AC Power Cord into the back of the Kiosk and the other end into a Power Outlet
2. Flip the switch from "0" to "1"

